

2GIG® GC3 Security & Automation System 2GIG-LTEV-A-GC3 | LTE Cellular Radio Module

10015237 B | Proprietary & Confidential



Installing the GC3 LTE Cellular Radio Module

The 2GIG GC3 LTE Cellular Radio Module is a snap-in unit providing the GC3 Security & Automation System with communication to the Central Station for alarm signaling and delivering (Over-the-Air) OTA firmware updates to the GC3 Panel. It also provides connectivity to the Remote Service Provider and 2-way voice communication.

The module includes a built-in antenna to provide a consistently strong communications signal. An optional external antenna Model 2GIG-ANT5XL-GC3 is also available.

Box Contents

Verify that the package includes the following:

- » —GC3 LTE Cellular Radio Module

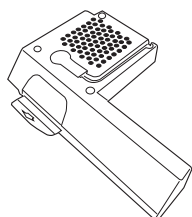

Figure 1 GC3 LTE Cellular Radio Module

Install/Replace the Cellular Radio Module

To install/replace the Cellular Radio Module into a system that is completely powered **OFF**:

1. Open and remove the hinged door from the GC3 Control Panel.

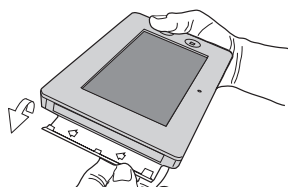

Figure 2 Cellular Radio Module—Hinged Door

2. If you are replacing a module, pull the tab to remove the Cellular Radio Module. Otherwise, skip this step.
3. Insert the new GC3 Cellular Radio Module until it clicks in place.

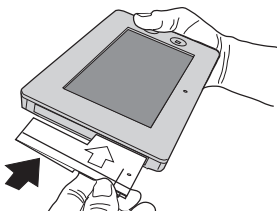

Figure 3 Inserting GC3 Cellular Radio Module

4. Replace the hinged door.
5. (Optional) Install the lock on the Cellular Radio Module bay door. See "(Optional) Lock/Unlock the Cellular Radio Module Door."
6. Power up the system and wait 30 to 40 seconds for the Control Panel to recognize the Cell Radio Module.
7. After installing the Cellular Radio Module, go to the **Installer Toolbox > System Configuration > Radio Test**. Then tap **Start Radio Test**.
8. When the test reads "Success", tap **Done**.

To install/replace the Cellular Radio Module into a system that is powered **ON**:

1. From the Home screen, go to **System Settings > Cell Radio Swap**.
2. Tap **Begin**.
3. Open and remove the hinged door from the GC3 Control Panel.
4. If you are replacing a module, pull the tab to remove the Cellular Radio Module. Otherwise, skip this step.
5. Insert the new CG3 Cellular Radio Module until it clicks into place.
6. Replace the hinged door.
7. (Optional) Install the lock on the Cellular Radio Module bay door. See "(Optional) Lock/Unlock the Cellular Radio Module Door".
8. Tap **Done**.
9. Tap **Radio Test** and then tap **Start Radio Test**.
10. When the test reads "Success", tap **Done**.

(Optional) Lock/Unlock the Cellular Radio Module Door

The Cellular Radio Module fits into the bay on the side of the GC3 Panel and features a built-in door lock under the faceplate. The Control Panel ships with the door-lock screw in the UNLOCK position. To limit the possibility of someone removing the door, installers have the option of moving the screw to the LOCK position.

To lock and unlock the Cellular Radio Module door:

1. Use your fingertips or carefully insert a screwdriver at the edge of the faceplate. Then gently pry the faceplate from the chassis.

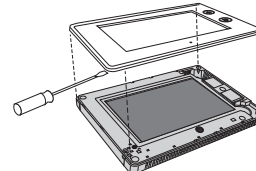

Figure 4 GC3 Panel—Removing Faceplate

2. Remove the door locking screw from the UNLOCK position on the right.

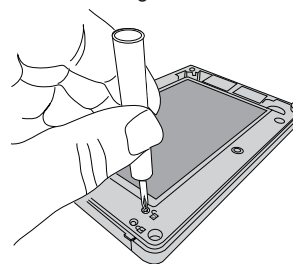

Figure 5 GC3 Panel—UNLOCK position

3. Install the door locking screw into the LOCK position on the left. This locks the hinged door on the GC3 Control Panel.

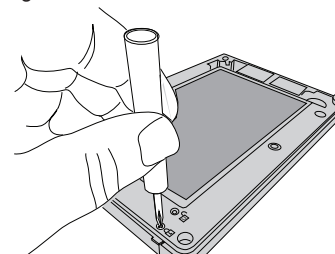

Figure 6 GC3 Panel—LOCK position

4. Snap the faceplate back on the GC3 Control Panel.

2GIG® GC3 Security & Automation System 2GIG-LTEV-A-GC3 | LTE Cellular Radio Module

10015237 B | Proprietary & Confidential



Limited Warranty

This Nortek Security & Control LLC product is warranted against defects in material and workmanship for two (2) years. **This warranty extends only to wholesale customers** who buy direct from Nortek or through Nortek's normal distribution channels. **Nortek Security & Control LLC does not warrant this product to consumers.** Consumers should inquire from their selling dealer as to the nature of the dealer's warranty, if any.

There are no obligations or liabilities on the part of Nortek Security & Control LLC for consequential damages arising out of or in connection with use or performance of this product or other indirect damages with respect to loss of property, revenue, or profit, or cost of removal, installation, or re-installation. All implied warranties, including implied warranties for merchantability and implied warranties for fitness, are valid only until the warranty expires. This Nortek Security & Control LLC Warranty is in lieu of all other warranties express or implied.

All products returned for warranty service require a Return Authorization Number (RA#). Contact Returns at 1-855-546-3351 for an RA# and other important details.

Support Services

Should you require support services for this system, contact 2GIG Technical Support at Nortek Security & Control.

For support in the USA and Canada, contact 2GIG Technical Support at Nortek Security & Control:

- » **Telephone:** 855-2GIG-TECH
- » **Email:** 2gigtechsupport@nortek.com
- » **Dealer Site:** dealer.2gig.com
- » **Websites:** www.nortekcontrol.com and www.2gig.com

For support outside of the USA or Canada, contact your regional 2GIG distributor. For a list of distributors in your region, visit the websites above.