

Knowledge Base

powered by  **ALARM.COM**[®]

- Quick Actions

[Home](#) » [For Partners](#) » [Installation and Troubleshooting](#) » [Video Devices](#) » [1080p Mini-Bullet Camera \(ADC-VC727P\)](#)

1080p Mini-Bullet Camera (ADC-VC727P) - Installation Guide

Last updated: Jun 27, 2022



Add to Binder

Pre-installation checklist

- ADC-VC727P
- AC power adapter (required for non-PoE connections) (sold separately)
- Router with broadband Internet connection
- (Cable, DSL, or Fiber Optic) and an open Ethernet port
- A computer or mobile device with Internet access
- An Ethernet / Cat5e cable
- Username and password for the Alarm.com account to which the camera is added

Overview

Q How can we help you?



- 1 LED indicator
- 2 Camera label with MAC Address
- 3 MicroSD card slot
- 4 Reset button
- 5 Ball joint mount
- 6 12 VDC power connector
- 7 RJ45 ethernet interface

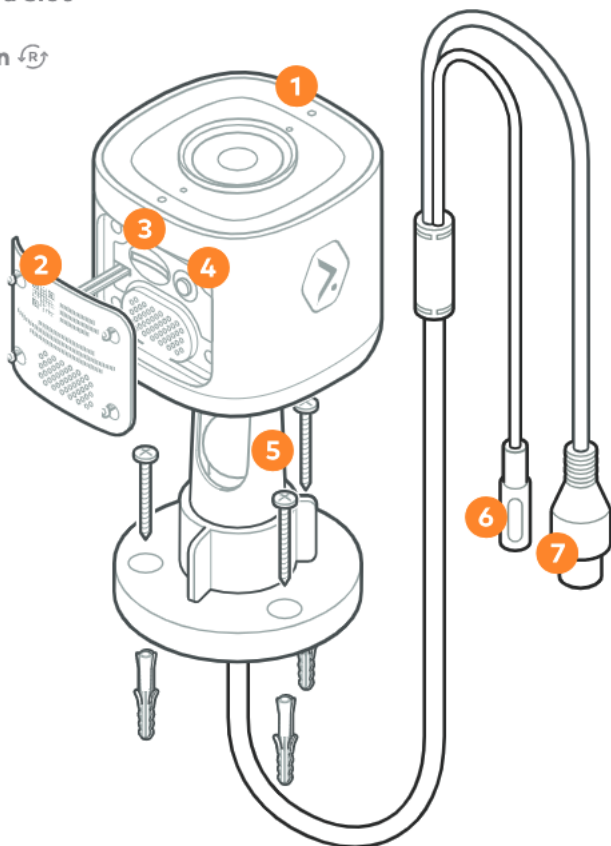

LED reference

LED	Off	
Description	Power off	
LED	Solid green	
Description	Connected to Alarm.com	
LED	Blinking green	
Description	Local network connection	
LED	Blinking red and green	
Description	Reverting to factory default settings	
LED	Blinking red	
Description	Power on, camera booting	
LED	Solid red	



Description No local or Internet connection

Installation

Service provider technician - MobileTech installation ^

1. Log in to the MobileTech app.
2. Select the customer account.
3. Tap **Quick Actions**.
4. Tap **Add Device**.
5. Tap **Video**.
6. Follow the on-screen instructions.

Ethernet mode ^

Complete these steps prior to installing the camera in its final location:

1. Connect the camera to the router using an Ethernet cable.
2. If the Ethernet connection does not provide power, connect the camera to the optional AC power adapter (sold separately), and plug the adapter into a non-switched outlet.
3. Wait 2 minutes for the camera to boot up and connect to the Internet. The LED will be solid green when this process is complete.
4. Add the device to the account by either selecting the account using the MobileTech app or by using a web browser and entering the following URL:
www.alarm.com/addcamera (you will need the customer username and password).
5. Select the camera from the video device list or enter its MAC address to begin adding the camera. The camera's MAC address is located on the bottom of the device or on the packaging.
6. Follow the on-screen instructions to finish adding the camera.

You can now power down the camera.

Weather resistant RJ45 cap assembly

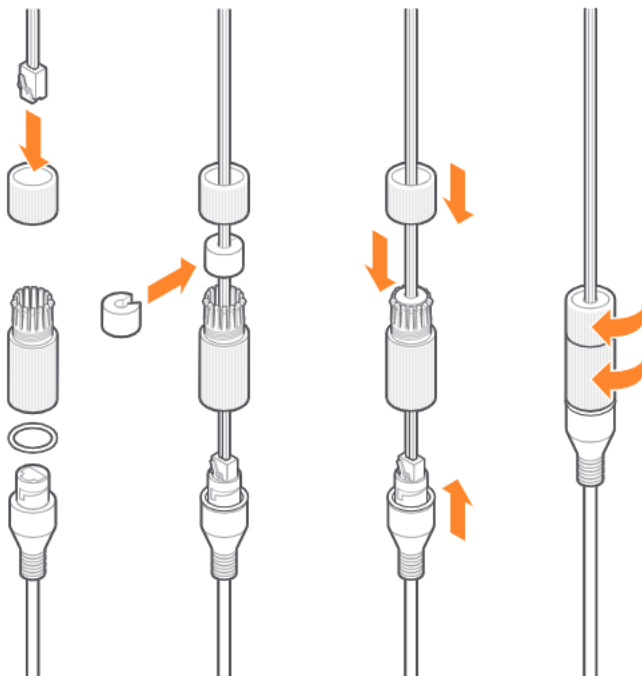

Camera mounting overview

1

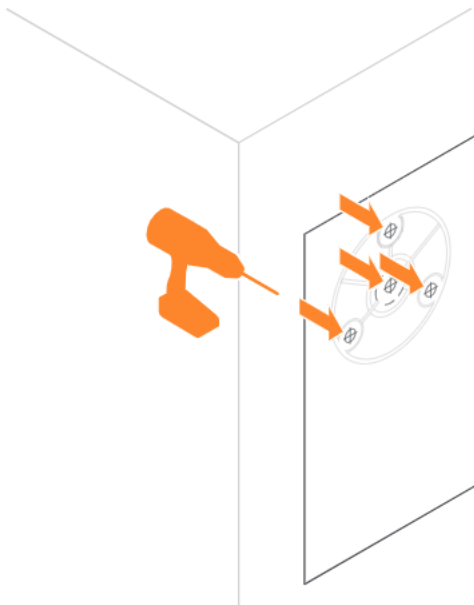

2

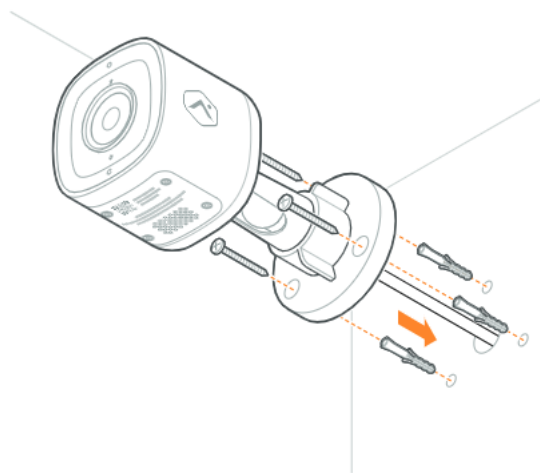

Camera mounting instructions

1. The camera should be mounted 8 feet or more above the ground on a flat surface, like a wall or ceiling.
2. Ensure that there are no obstructions near the camera. Obstructions can lead to poor night vision performance.
3. Use the included drill template to mark the desired location of the holes for the RJ45 ethernet interface and mounting screws. Drill a 1" hole in the center of the template for the RJ45 ethernet interface. If mounting to drywall, drill three 9/32" holes and insert the included M5 wall anchors. If mounting to a solid surface, like wood, drill three 1/8" pilot holes.
4. Connect the camera to ground. The ground location is indicated by the ground symbol. To ground the device, use the included nut to connect the ground wire to the camera, then connect the other end of the ground wire to an approved ground according to Article 250 of the National Electrical Code (NEC). If the camera needs to be removed in the future, ensure that the ground wire is removed last.
5. Connect the camera to a properly terminated, unplugged ethernet cable. Seal the connection using the included weather resistant RJ45 cap. For non-PoE connections, connect the 12VDC connector to an unplugged 12VDC adapter. Insert the cables and ground wire into the RJ45 ethernet interface clearance hole.
6. Line up the camera with the three holes created in step 4. Use the included M5x40mm screws to fasten the camera to the mounting surface.
7. Activate the Ethernet connection and connect the device to power.

Troubleshooting

- If you have issues connecting the camera to the account, power cycle the camera and try again.
- If issues persist, reset the camera to factory defaults. Press and hold the Reset button until the LED is flashing Green and Red (about 15 seconds), then release the button. The camera will reboot with factory defaults.
- If the camera was previously installed to another Alarm.com account, it will need to be deleted before it can be installed again.



Additional resources1. [Academy Online](#)

The Alarm.com Academy Online allows you to access online training courses anytime, anywhere from your computer or mobile device.

2. [Tips & Tools Podcast](#)

Keep the learning alive and get expert advice from our CORE Support team via the Alarm.com Academy Tips & Tools emails and our podcast series.

Article type:

[Installation](#)

Content type:

[Digital Guide](#)

Language:

[English](#)

Tags:

[727](#), [727P](#)

© Copyright 2022 Knowledge Base

Powered by CXone Expert ®

10308

[https://answers.alarm.com/Partner%2FInstallation_and_Troubleshooting%2FVideo_Devices%2F1080p_Mini-Bullet_Camera_\(ADC-VC727P\)%2F1080p_Mini-Bullet_Camera_\(ADC-VC727P\)-_Installation_Guide](https://answers.alarm.com/Partner%2FInstallation_and_Troubleshooting%2FVideo_Devices%2F1080p_Mini-Bullet_Camera_(ADC-VC727P)%2F1080p_Mini-Bullet_Camera_(ADC-VC727P)-_Installation_Guide)

eyJhbGciOiJIUzI1NiIsImtpZCI6Imh0dHBzOi8vbWluZHRvdWNoLmNvbS9hdXRodG9rZW4vZGVraS8xMDMwOCIsInR5cCI6IkpXVCJ9.eyJhdWQiOiJodHRwczovL2Fuc3dlnMtg

Copyright © 2000-2022, Alarm.com. All rights reserved.

Alarm.com and the Alarm.com Logo are registered trademarks of Alarm.com.

