

AL176ULX

Single Output Power Supply/Charger

Altronix AL176ULX Power Supply/Charger converts a 115VAC 60Hz input into a Class 2 Rated PTC protected power-limited 12VDC or 24VDC auto-resettable output.

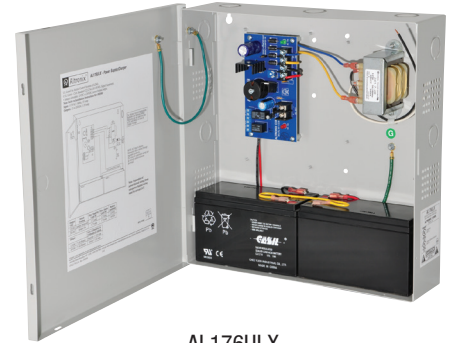

AL176ULX

Specifications

Input

Voltage 115VAC, 60Hz, 0.6A

Output

Class 2 Rated power-limited output

Voltage 12VDC or 24VDC selectable

Current 1.75A continuous max.

Other Short circuit and thermal overload protection

Battery Charging

Type Sealed lead acid or gel type

Failover Upon AC loss, instantaneous

Batteries are sold separately

Supervision

AC Failure Form "C" contacts

Low Battery Form "C" contacts

Indicators (LED)

Input Input voltage is present

DC Output Powered

Agency Listings

UL UL294 (Access Control)

cUL CSA Standard C22.2
No.205-M1983, Signal Equipment

MEA NYC Dept. of Buildings Approved

Physical and Environmental

Dimensions (H x W x D)

Enclosure:

13.5" x 13" x 3.25" (342.9mm x 330.2mm x 82.55mm)

Shipping:

15" x 13.875" x 4.75" (381mm x 352.4mm x 120.6mm)

Enclosure accommodates up to two (2) 12VDC/7AH batteries

Weight (approx.)

Product: 8.4 lb. (3.81 kg)

Shipping: 9.4 lb. (4.26 kg)

Temperature

Operating: 0°C to 49°C (32°F to 120°F)

Storage: -20°C to 70°C (-4°F to 158°F)

Relative Humidity 85% +/- 5%

BTU/Hr. (approx.)

12VDC: 11 BTU/Hr.

24VDC: 22 BTU/Hr.

Lifetime Warranty

Altronix Corporation | 140 58th St | Brooklyn, NY 11220 USA

phone: +1 718.567.8181 | fax: +1 718.567.9056 | email: info@altronix.com | www.altronix.com

AL176ULX

Single Output Power Supply/Charger

Dimensions and Drawing

Dimensions (H x W x D approximate)

13.5" x 13" x 3.25" (342.9mm x 330.2mm x 82.6mm)

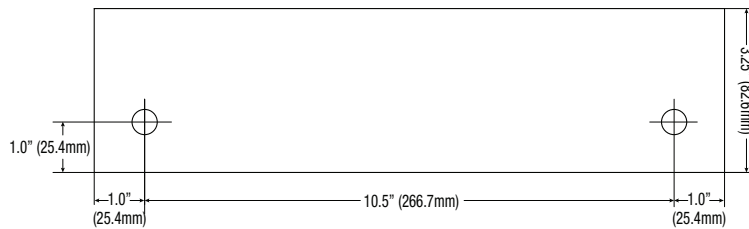
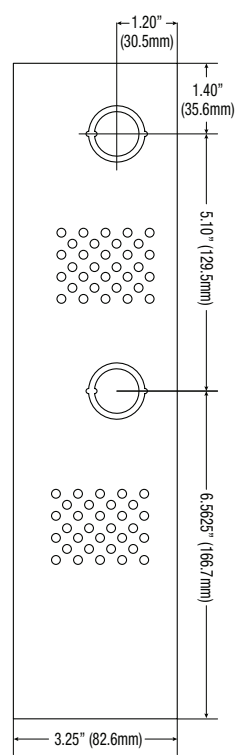
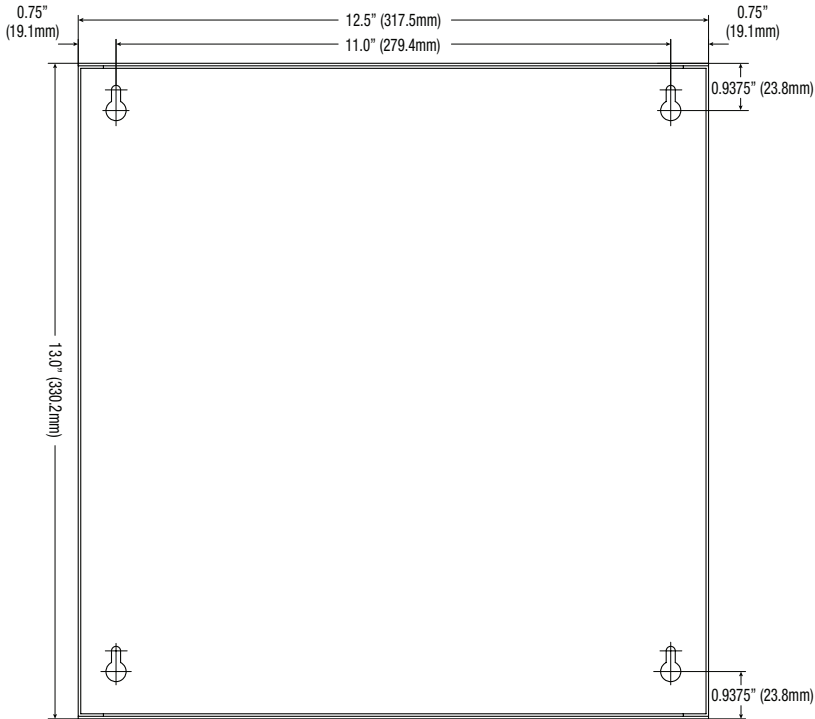
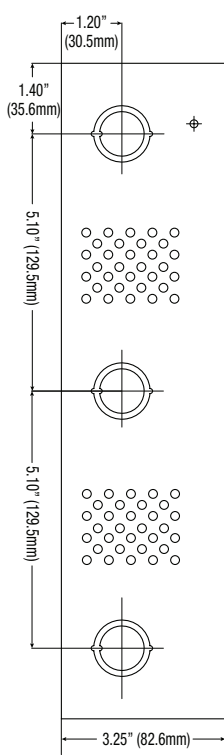
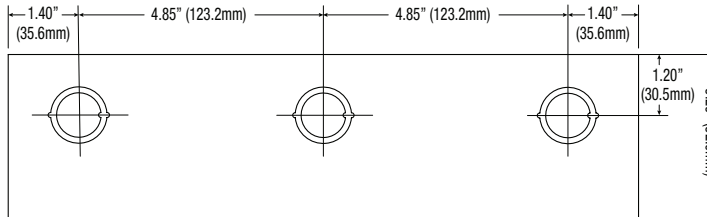

Lifetime Warranty

Altronix Corporation | 140 58th St | Brooklyn, NY 11220 USA

phone: +1 718.567.8181 | fax: +1 718.567.9056 | email: info@altronix.com | www.altronix.com