

# AL600ULX Series

## Power Supply/Chargers

Altronix AL600ULX series power supply/chargers convert a 115VAC, 60Hz input into a single fused, four (4), eight (8) or sixteen (16) fuse or PTC protected outputs. Outputs are selectable for 12VDC or 24VDC with a total of 6A max.

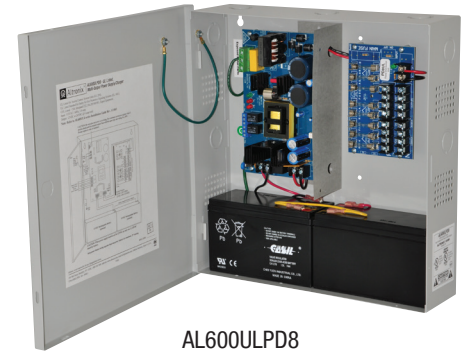

AL600ULPD8

### Key Features

- Available with 1, 4, 8 or 16 outputs
- Fused or PTC protected outputs
- Supervision:
  - AC Fail.
  - Battery Fail and Battery Presence
- Built-in charger for sealed lead acid or gel type batteries
- Instantaneous transfer to stand-by batteries
- Short circuit and overload protection
- AC input and DC output options
- UL Listed in the U.S. and Canada
- CSFM and MEA Approved
- Lifetime Warranty
- All units are available in grey or red enclosure

### AL600ULX Series Power Supply Configuration Reference Chart

Altronix Model Number	Input Rating: 115VAC, 60Hz	Input Fuse Rating	Total Output Rating (A)	Power Distribution Module	Class 2 Rated Power-Limited Outputs (auto-resettable)	Number of Outputs	Fused Output Ratings	PTC Output Ratings	Accommodates Batteries
AL600ULX	3.5A	5A/250V	6A	N/A	-	1	6A	-	Two (2) 7AH
AL600ULXX				-	1	6A	-	Two (2) 12AH	
AL600ULPD4				PD4UL	-	4	3.5A	-	Two (2) 7AH
AL600ULXPD4				PD4UL	-	4	3.5A	-	Two (2) 12AH
AL600ULPD4CB				PD4ULCB	✓	4	-	2.5A	Two (2) 7AH
AL600ULXPD4CB				PD4ULCB	✓	4	-	2.5A	Two (2) 12AH
AL600ULPD8				PD8UL	-	8	3.5A	-	Two (2) 7AH
AL600ULXPD8				PD8UL	-	8	3.5A	-	Two (2) 12AH
AL600ULPD8CB				PD8ULCB	✓	8	-	2.5A	Two (2) 7AH
AL600ULXPD8CB				PD8ULCB	✓	8	-	2.5A	Two (2) 12AH
AL600ULXPD16				Two (2) PD8UL	-	16	3.5A	-	Two (2) 12AH
AL600ULXPD16CB				Two (2) PD8ULCB	✓	16	-	2.5A	Two (2) 12AH

#### Lifetime Warranty



# AL600ULX Series

Power Supply/Chargers

## Specifications

### Input

Voltage 115VAC, 60Hz, 3.5A max.  
Fusing 5A/250V

### Outputs

Voltage 12VDC or 24VDC selectable  
Current 6A @ 12VDC or 24VDC continuous max.  
Protection Fused 3.5A / PTC 2.5A  
Other Overvoltage protection  
Filtered and regulated

### Battery Charging

Capacity 7AH/12VDC (1 or 2 within enclosure)  
12AH/12VDC (requires larger "X" enclosure)  
40AH/65AH (requires separate enclosure)  
Type Sealed lead acid or gel type  
Failover Upon AC loss, instantaneous  
Batteries are sold separately

### Supervision

AC Failure Form "C" contacts  
Battery Form "C" contacts

### Indicators (LED)

Input 115VAC is present  
DC Output Powered  
Battery Discharged or not connected

### Agency Listings

#### All Models:

#### UL:

UL294 Access Control System Units  
UL1481 Power Supplies for  
Fire Protective Signaling Systems

#### cUL:

CSA C22.2 No.205 Signal Equipment

#### AL600ULX and AL600ULXX only:

CSFM California State Fire Marshall Approved  
MEA NYC Department of Buildings Approved

#### AL600ULX only:

FM Factory Mutual Approved

## Physical and Environmental

### Dimensions (H x W x D)

#### AL600ULX, AL600ULPD4(CB), AL600ULPD8(CB):

Enclosure: 13.5" x 13" x 3.25" (342.9mm x 330.2mm x 82.55mm)  
Shipping: 15" x 13.875" x 4.75" (381mm x 352.4mm x 120.6mm)

#### AL600ULXX, AL600ULXP4(CB),

#### AL600ULXP8(CB), AL600ULXP16(CB):

Enclosure: 15.5" x 12" x 4.5" (393.7mm x 304.8mm x 114.3mm)  
Shipping: 16.5" x 13.5" x 6" (419.1mm x 342.9mm x 152.5mm)

### Weight (approx.)

Model	Product Weight	Shipping Weight
AL600ULX	7.05 lb. (3.2 kg)	8.9 lb. (4.1 kg)
AL600ULXX	8.65 lb. (3.92 kg)	10.95 lb. (4.97 kg)
AL600ULPD4(CB)	7.2 lb. (3.27 kg)	9.05 lb. (4.1 kg)
AL600ULXP4(CB)	8.7 lb. (3.95 kg)	11.05 lb. (5.01 kg)
AL600ULPD8(CB)	7.3 lb. (3.31 kg)	9.15 lb. (4.15 kg)
AL600ULXP8(CB)	8.8 lb. (4.0 kg)	11.15 lb. (5.06 kg)
AL600ULXP16(CB)	8.95 lb. (4.06 kg)	11.25 lb. (5.1 kg)

### Temperature

Operating: 0°C to 49°C (32°F to 120°F)  
Storage: -20°C to 70°C (-4°F to 158°F)

### Relative Humidity

85% +/- 5%

### BTU/Hr (approx.)

12VDC: 37 BTU/Hr.  
24VDC: 74 BTU/Hr.

## Lifetime Warranty

Altronix Corporation | 140 58th St | Brooklyn, NY 11220 USA

phone: +1 718.567.8181 | fax: +1 718.567.9056 | email: info@altronix.com | www.altronix.com

# AL600ULX Series

Power Supply/Chargers

## Dimensions and Drawing

AL600ULX, AL600ULPD4(CB), AL600ULPD8(CB) Dimensions (H x W x D approximate)

13.5" x 13" x 3.25" (342.9mm x 330.2mm x 82.6mm)

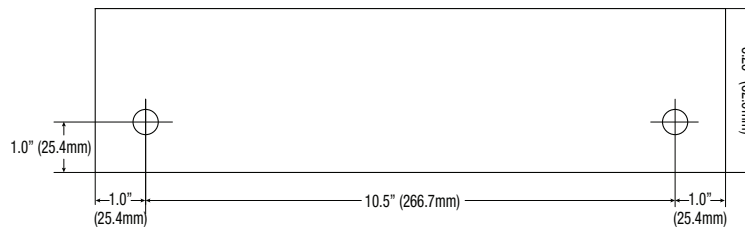
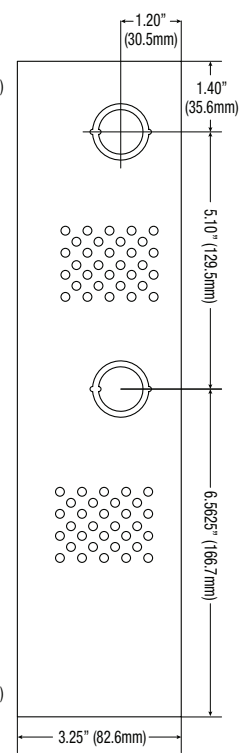
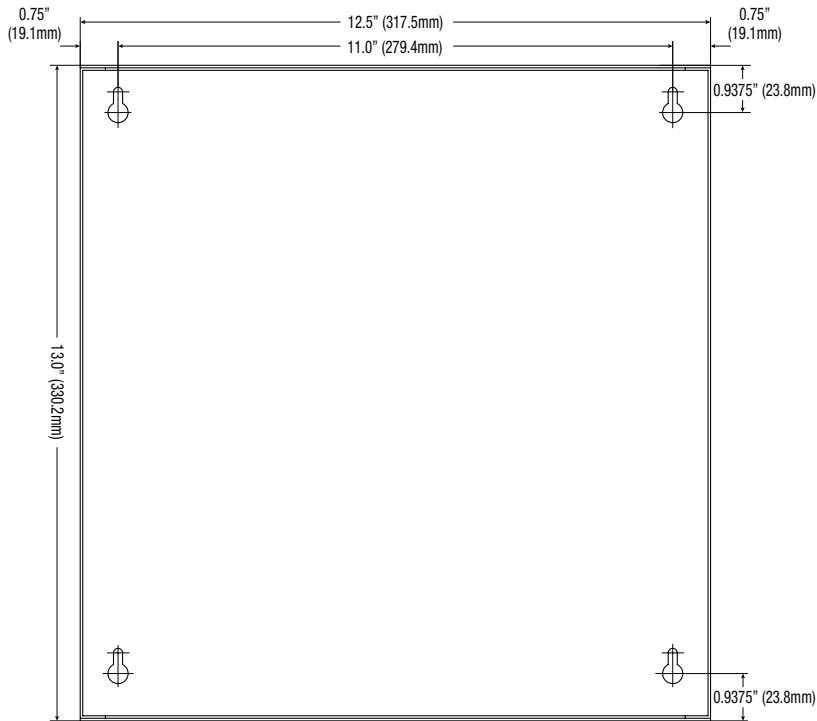
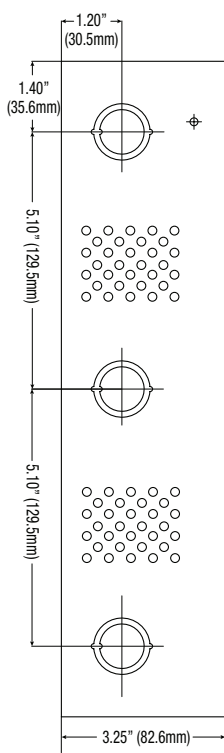
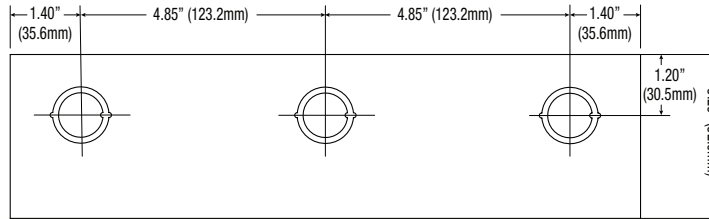

### Lifetime Warranty

Altronix Corporation | 140 58th St | Brooklyn, NY 11220 USA

phone: +1 718.567.8181 | fax: +1 718.567.9056 | email: info@altronix.com | www.altronix.com

### Dimensions and Drawing

AL600ULXX, AL600ULXPD4(CB), AL600ULXPD8(CB), AL600ULXPD16(CB) Dimensions (H x W x D approximate)  
 15.5" x 12" x 4.5" (393.7mm x 304.8mm x 114.3mm)

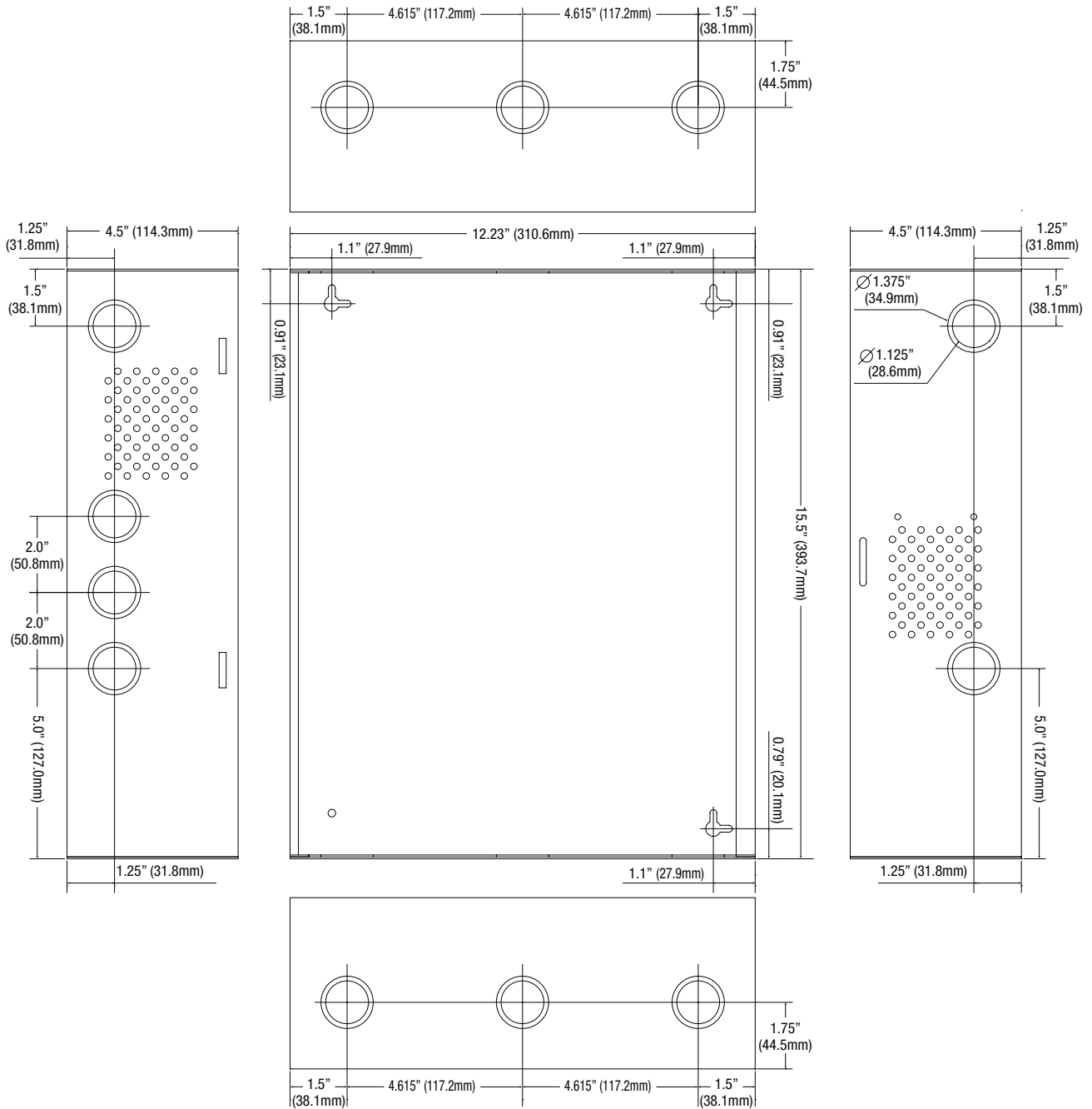

### Lifetime Warranty

Altronix Corporation | 140 58th St | Brooklyn, NY 11220 USA

phone: +1 718.567.8181 | fax: +1 718.567.9056 | email: info@altronix.com | www.altronix.com