



Continental E-Access Embedded Access Control Platform is a new self-contained and ready out-of-the box solution, for a few doors, scalable to over 500



E-Access is a comprehensive embedded solution that's simply more cost-effective to deploy because it's Web-Browser-Managed, there's no more software to load or license.\*\* It includes a full line of E-Access-dedicated\* controllers and ultra-fast readers, a dedicated App & integrated mobile credential - All using today's latest, proven technologies.

### Why E-Access?

- Continental's New E-Access® is an all-new embedded access control platform, for systems from 1 to 128 doors, up to 64 panels or controllers
- For even larger requirements, add a 2nd server & scale to 256 panels/512 doors
- **Faster & More Cost-Effective - No Software to load or license** (after one-time cloud activation\*\*)
- **Use Any Popular Web Browser, Anywhere**, with E-Access' Embedded Linux Operating System
- **Comprehensive Scalable Line-up** of 1-, 2- and 4-Door Expandable Controllers with choice of super-fast readers NFC, Prox, BLE, HF/Mifare
- **Management App with Integrated Mobile Credential Included**
- **No-Touch Bluetooth Mobile Credentials & Automated 1-Click Credential Issuing**
- **Fast System Setup** - Configuration Wizard; Auto-Populates holidays; Integrated flat file import tool; Bulk uploading of users & credentials
- **Hybrid Access Control** - Embedded Solution with the advantages of an onsite system
- **Secure End-to-End Communications, SSL, AES 256 Bit Encryption**
- **Backed by Continental's 5-Year Warranty** (3-Years on Reader with Keypad)



# E•Access™ Embedded Single-Door Controller



**CAE-1DC** 1-Door Controller, with Mobile App, requires 12 VDC power (sold separately)

## FEATURES:

- Simple to use, Self-Contained, Scalable Access Control Solution
- Each controller functions as a Server, expansion panel or elevator module
- Ready out of the box, browser-managed
- Embedded Linux Operating System
- 2 Reader Ports – 1 In / 1 Out
- 2 Form C Relays – 1 Lock / 1 Auxiliary
- 3 Inputs – 1 Request to Exit, 1 Door Position Switch, 1 Auxiliary
- ETL / UL294
- 1 Gigabit Auto Sensing Ethernet Port
- Includes Mounting Bracket
- 5-Year Hardware Warranty



**POE-1DC**  
12VDC 2A POE Power  
Supply Accessory

# E•Access™ Embedded 2-Door Controller

**CAE-2DC** 2-Door Controller, expandable up to 4 doors

## FEATURES:

- Simple to use, Self-Contained, Scalable Access Control Solution
- Each controller functions as a Server, expansion panel or elevator module
- Ready out of the box, browser-managed
- Embedded Linux Operating System
- Expandable to 4 doors in same housing with CAE-ACM
- 4 Reader Ports – 2 In / 2 Out
- 4 Form C Relays – 2 Lock / 2 Auxiliary
- 6 Inputs – 2 Request to Exit, 2 Door Position Switch, 2 Auxiliary
- ETL / UL294
- 5-Year Hardware Warranty

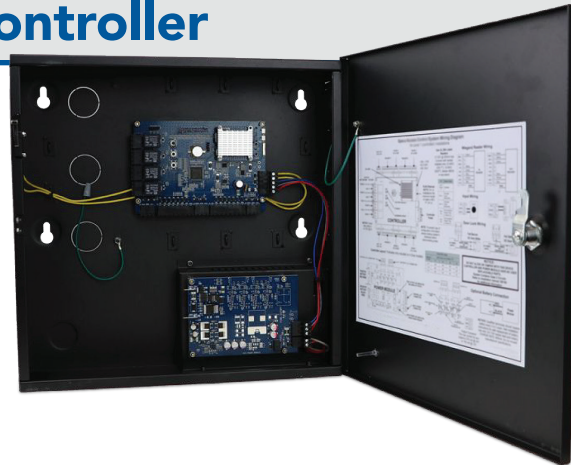

Option - **CAE-2DMPL** 2-Door Controller, expandable up to 4 doors, with Power Package, includes selectable 12 or 24VDC, using individual auto-resetting fused outputs

# E•Access™ Embedded 4-Door Controller

## CAE-4DM 4-Door Controller

### FEATURES:

- Simple to use, Self-Contained, Scalable Access Control Solution
- Each controller functions as a Server, expansion panel or elevator module
- Ready out of the box, browser-managed
- Embedded Linux Operating System
- 8 Reader Ports – 4 In / 4 Out
- 8 Form C Relays – 4 Lock / 4 Auxiliary
- 12 Inputs – 4 Request to Exit, 4 Door Position Switch, 4 Auxiliary
- ETL / UL294
- 5-Year Hardware Warranty

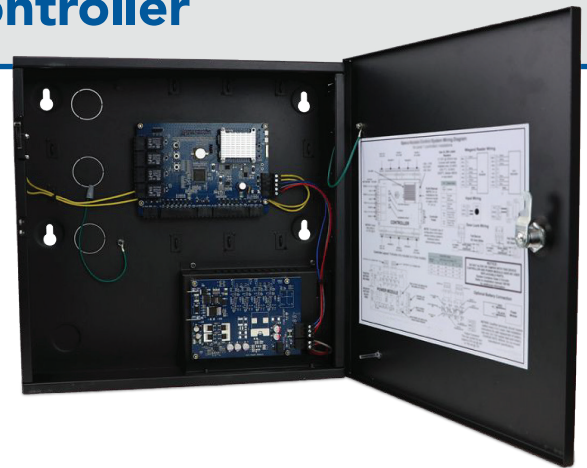

Option - **CAE-4DMPL** 4-Door Controller, with Power Package, includes selectable 12 or 24VDC, using 4ea. auto-resetting fused outputs

# E•Access™ Readers

### FEATURES:

- Ultra-Fast transaction times, under a second
- Wiegand & OSDP support; Auto-Detects either over the same wires
- Bluetooth Low Energy
- No-Touch Bluetooth Mobile Credentials & Automated 1-Click Credential Issuing
- 5-Year Hardware Warranty (except 3-Years on Keypad model (ET25))



### MODELS:

**CAE-ET5** Mullion Mount Reader NFC, HF / 13.5 MHz Mifare

**CAE-ET10** Mullion Mount Reader NFC, Proximity, Bluetooth, HF / 13.5 MHz Mifare

**CAE-ET20** Single Gang Reader NFC, Proximity, Bluetooth, HF / 13.5 MHz Mifare

**CAE-ET25** Single Gang Reader with Keypad NFC, Proximity, Bluetooth, HF / 13.5 MHz Mifare

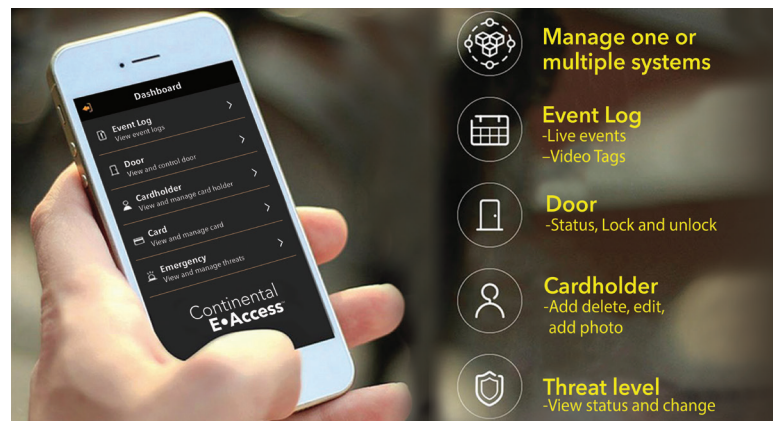

**Manage one or multiple systems**

**Event Log**  
-Live events  
-Video Tags

**Door**  
-Status, Lock and unlock

**Cardholder**  
-Add delete, edit, add photo

**Threat level**  
-View status and change

# Continental E-Access Controller Specifications

Model	CAE-1DC	CAE-2DM	CAE-2DMPL	CAE-4DM	CAE-4DMPL
<b>Wiegand Readers; Doors</b>	2 Readers for 1 Door only, 1 In / 1 Out Reader	2, Expandable to 4 total, 1 In / 1 Out Reader for up to 2 Doors or 1 In Reader for up to 4 Doors	2, Expandable to 4 total, 1 In / 1 Out Reader for up to 2 Doors or 1 In Reader for up to 4 Doors	8, 1 In / 1 Out Reader for up to 4 Doors	8, 1 In / 1 Out Reader for up to 4 Doors
<b>Scalable for Max. Number of Doors / System</b>	128 Doors, up to 64 Panels; or w/ 2nd Server 256 Panels / 512 Doors	128 Doors, up to 64 Panels; or w/ 2nd Server 256 Panels / 512 Doors	128 Doors, up to 64 Panels; or w/ 2nd Server 256 Panels / 512 Doors	128 Doors, up to 64 Panels; or w/ 2nd Server 256 Panels / 512 Doors	128 Doors, up to 64 Panels; or w/ 2nd Server 256 Panels / 512 Doors
<b>Request to Exit (REX) Inputs</b>	1 Total, One for Each Door	2 Total, One for Each Door	2 Total, One for Each Door	4 Total, One for Each Door	4 Total, One for Each Door
<b>Door Position (status) Inputs</b>	1 Total, One for Each Door	2 Total, One for Each Door	2 Total, One for Each Door	4 Total, One for Each Door	4 Total, One for Each Door
<b>Auxiliary Inputs</b>	1 Total, General Purpose	2 Total, General Purpose	2 Total, General Purpose	4 Total, General Purpose	4 Total, General Purpose
<b>Tamper Digital Input</b>		Yes	Yes	Yes	Yes
<b>Power Fault Digital Input</b>		Yes	Yes	Yes	Yes
<b>Door Lock Outputs</b>	1 Form C Relay, 24V @ 1.0A	2 Form C Relay, 24V @ 2.0A	2 Form C Relay, 24V @ 2.0A	4 Form C Relay, 24V @ 2.0A	4 Form C Relay, 24V @ 2.0A
<b>Auxiliary Outputs</b>	1 Form C Relay, 24V @ 1.0A	2 Form C Relay, 24V @ 2.0A	2 Form C Relay, 24V @ 2.0A	4 Form C Relay, 24V @ 2.0A	4 Form C Relay, 24V @ 2.0A
<b>Processor</b>	Quad Core Cortex, 1.5 GHz	Quad Core Cortex, 1.5 GHz	Quad Core Cortex, 1.5 GHz	Quad Core Cortex, 1.5 GHz	Quad Core Cortex, 1.5 GHz
<b>Memory</b>	1 GB DDR3 & 8 GB eMMc	1 GB DDR3 & 8 GB eMMc	1 GB DDR3 & 8 GB eMMc	1 GB DDR3 & 8 GB eMMc	1 GB DDR3 & 8 GB eMMc
<b>Operating System</b>	Embedded Linux	Embedded Linux	Embedded Linux	Embedded Linux	Embedded Linux
<b>Fast Transaction Processing</b>	> 60 per second	> 60 per second	> 60 per second	> 60 per second	> 60 per second
<b>System Power Requirements</b>	Regulated 12VDC @ 2A, Class 2 (not supplied)	115VAC @ 1.5A	115VAC @ 1.5A	115VAC @ 1.5A	115VAC @ 1.5A
<b>Operating Temperature</b>	50°F to 95°F (10°C to 35°C)	50°F to 95°F (10°C to 35°C)	50°F to 95°F (10°C to 35°C)	50°F to 95°F (10°C to 35°C)	50°F to 95°F (10°C to 35°C)
<b>Enclosure Size (W x H x D)</b>	3.2" x 3.0" x 1.3"	14.25" x 14.25" x 3.75"	14.25" x 14.25" x 3.75"	14.25" x 14.25" x 3.75"	14.25" x 14.25" x 3.75"
<b>Internal Power Supply</b>	350mA @ 12V, (Power not included)	Controller & Readers Only	Controller, Readers & 12V and 24V DC for Door Locks	Controller & Readers Only	Controller, Readers & 12V and 24V DC for Door Locks
<b>Lock Output Power</b>			12VDC, 700 mA 24 VDC, 350mA		12VDC, 700 mA 24 VDC, 350mA
<b>Battery Backup</b>		Controllers & Readers Only	Controllers & Readers, & Door Locks	Controllers & Readers Only	Controllers & Readers, & Door Locks
<b>Rechargeable Backup Battery (Sold separately)</b>		12V, 7AH, Sealed Lead Acid	12V, 7AH, Sealed Lead Acid	12V, 7AH, Sealed Lead Acid	12V, 7AH, Sealed Lead Acid
<b>Standby Power Requirement</b>	350mA @ 12V	400mA @ 12V	450mA @ 12V	400mA @ 12V	450mA @ 12V
<b>Reader Power</b>	300mA @ 12V Max per Reader; 600mA @ 12V Max per System	300mA @ 12V Max per Reader; 1000mA @ 12V Max per System	300mA @ 12V Max per Reader; 1000mA @ 12V Max per System	300mA @ 12V Max per Reader 1000mA @ 12V Max per System	300mA @ 12V Max per Reader 1000mA @ 12V Max per System



CONTINENTAL ACCESS, A DIVISION OF NAPCO SECURITY TECHNOLOGIES, INC.

355 BAYVIEW AVE., AMITYVILLE, NY 11701

1.800.645.9445 | 631.842.9400 | FAX 631.842.9135 | WWW.CIACCESS.COM

\* Note: E-Access controllers are not supported on the standard Continental CA4K Enterprise platform. E-Access uses its own dedicated web-browser based management platform and App; not CA4K cross-compatible. \*\*Note: E-Access does require a one-time cloud activation license. For full information and specs. always consult tech docs or ask your Continental Rep. E-Access is a trademark of Continental/NAPCO A797 2021.7