



EGT-250 Entraguard Titanium™

DATA SHEET

Standard Features for Telephone Entry



- Stand alone functionality or seamless integration with Keri's access control system and Doors.Net software for real access control and telephone entry integration
- Four line, 20 character per line, soft white supertwist LCD display
- Do not disturb Time Zones
- Three 80 character, programmable, scrolling pages for instructions and messages with automatic timed rotation
- 250 tenant capacity on all units, customer does not pay for extra capacity
- Up to 6-digit directory code, up to 5-digit Entraguard ID codes (PINs), up to 15-digit telephone numbers
- Networkable to manage multiple doors via RS-485
- Time Zone restrictions for calling tenants and for PINs
- Links a visitor to the resident who allowed entry
- Telephone entry units and access control units can be combined on a single network for a total of 128 controller units
- Flexible connectivity: RS-232, Modem, TCP/IP
- Stores up to 3,640 events, manages up to 255 individual sites
- Weather and vandal resistant housing
- Programmable talk time, tone dialing, adjustable volume
- Quick disconnect terminals
- Mylar™ speaker with superior sound
- Heavy duty door and alarm relays, door forced open and door held open alarms
- Built-in surge protection, non volatile memory
- Powerful Doors.Net Access Control Software with full access control features: time zones, temporary users, online programming, operator security levels, multiple remote site management

The **Entraguard Titanium** represents a breakthrough in telephone entry by providing 250 tenant capacity with a 4-line LCD display in a small, attractive package, all at an extremely low price. The small footprint allows the Titanium to be mounted almost anywhere providing first line access control for visitors to office buildings as well as residential complexes. It is housed in a rugged stainless steel enclosure with built-in hood so that it can withstand the toughest environments. The Titanium can be programmed to have three rotating messages on display.

Like its sister products, the Entraguard Silver and Platinum, the Titanium provides the best telephone entry/access control marriage by letting the unit function as a node on a PXL controller network and putting both applications under the acclaimed Doors.Net software umbrella for a seamless integration of the two. This allows the telephone entry unit to become part of an advanced access control network with powerful access control features and options.

Each Entraguard Titanium also has two extra relay outputs that can be used in a variety of ways including turning on a lobby light, unlocking more than one interior entrance, etc. These can be initiated by tone commands from the tenant's location based on an access granted decision. An on-board modem is also included for remote programming. Programming can also take place via direct connect RS-232 or TCP/IP.



EGT-250 Entraguard Titanium™

DATA SHEET - Page 2 of 2

Access Control Features

- Real, integrated access control with PXL-500 or NXT controllers- the Titanium becomes part of a Keri access control network
- Simple, one button auto-configuration
- 32 time zones, 3 holiday schedules
- Unlimited access control groups
- Automatically expiring Entraguard IDs (PINs) and cards
- Time Zones on Entraguard IDs (PINs) and cards, as well as doors and gates
- Full reporting of events
- TCP/IP connectivity
- Direct door operation from PC
- Automatic lock and unlock of doors and gates
- Assignable inputs and outputs (when using an optional SB-593 on a PXL-500)
- Rollcall/track, muster
- Image capture and optional badge printing
- Remote online management of multiple sites
- System operator security levels with configurable privileges

Special Telephone Entry Features

- Do not Disturb Call Feature - programmable for individual tenants
- Do not Display Name Feature - programmable on a per tenant basis
- Remote online management of multiple sites
- Ability to link visitors to the residents who allowed them entry
- Ability to update several units in one pass

General Features:

- Surface or recess mount
- Weather and vandal resistant housing
- Postal lock provision
- Non-volatile memory
- Built-in surge protection plus surge protection kit
- Programmable talk time
- Door forced open and door held open alarms
- Tone dialing
- Alarm output relay
- Adjustable volume control
- Maintenance free LED lighting
- Mylar speaker with superior sound
- Quick disconnect terminals

Specifications:

- Capacity: Up to 250 Tenants
- Outputs: Door Relay, Alarm Relay, 2 additional programmable relays
- Operating Temperature: +5° to 140° F (-15° to 60° C) with heater: -20° to 140° F (-29° to 60° C)
- Input Power: 12 VDC @ 1 A
- Current Draw: 750 mA
- Relay Contact Rating: 1 A @ 24 VDC
- Size: 12.07" H x 5.58" W x 4.525" D (30.7 cm x 14.2 cm x 11.5 cm)
- Weight: 7.05 lbs (3.20 kg)
- Material: 14 gauge stainless steel
- Warranty: 2 years
- Finish: Brushed Stainless Steel

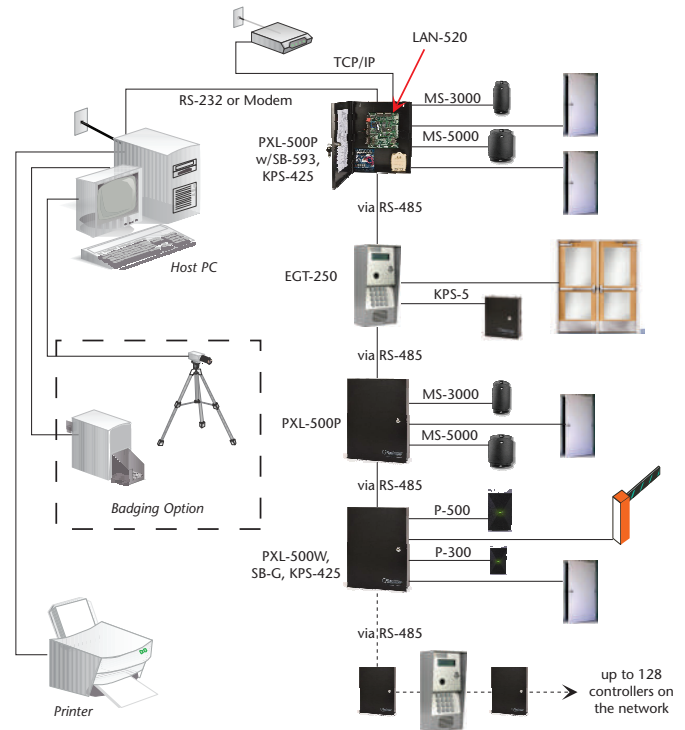

ORDERING INFORMATION:

Model #	Description
EGT-250HF	Entraguard Titanium Telephone Entry System - Hands Free
<i>*For pre-installed color camera, add "-CO" to the above model number</i>	

RELATED PRODUCTS:

Model #	Description
CU-EGT-750	Firmware upgrade for Titanium/Silver Entraguard units
EGH-12	Heater Kit for Entraguard Units
EGT-PL	Titanium Postal Lock Kit - Field Installation
EPS-58	Power Supply Kit for Entraguard Units
RMK-65	Recess Mount Kit for Titanium

Options / Accessories:

- Camera
- Postal Lock
- Pedestal Mount
- Recessed Wall Mount Kit
- Heater (for operation below 5° F/-15° C)
- No Phone Line System

Specifications are subject to change without notice. All trademarks are the property of their respective owners.

When using Entraguard products in a dial-up application, Keri requires the use of an approved modem. Please refer to the Recommended Peripherals list on the web site or contact Keri customer service.



Presented By: