

# TANE-60 QC QUICK CONNECT SURFACE MOUNT CONTACTS

2"L x .37"W x .28"H Surface Mount Quick Connect Type (with Super Stick adhesive tape)



Contact Size: 2"L x .37"W x .28"H

(50.8mm x 9.5mm x 7.1mm)

Standard Magnet Size: 2"L x .37"W x .28"H

(50.8mm x 9.5mm x 7.1mm)

Standard Gap: .71" (18mm)

Colors: White, Brown, Gray, Tan, Black

## Specifications

| Part Number    | Gap Inch(mm) | Loop Open/Closed | Reed Form       | Max. Contact Rating (W) | Max. Initial Contact Resistance (mΩ) | Max. Switching Voltage (V) | Max. Switching Current (A) |
|----------------|--------------|------------------|-----------------|-------------------------|--------------------------------------|----------------------------|----------------------------|
| TANE-60 QC     | .71"(18)     | CLOSED           | Normally Open   | 10                      | 100                                  | AC110/DC100                | 0.5                        |
| *TANE-61B QC   | .43"(11)     | OPEN             | Normally Closed | 3                       | 100                                  | AC30/DC30                  | 0.2                        |
| *TANE-60 QC WG | 1"(25)       | CLOSED           | Normally Open   | 10                      | 100                                  | AC110/DC100                | 0.5                        |

OPERATING TEMPERATURE: -40°C to +60°C

\*Not UL Listed

## Outline Dimensions

Unit: inch(mm)

### TANE-60 QC/TANE-61B QC

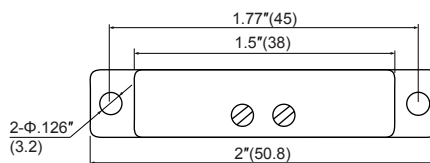
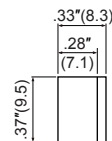
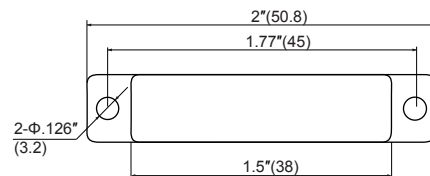
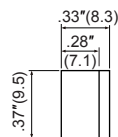

The Best Industry Guarantee Since 1984®  
**TANE ALARM PRODUCTS**

906 JERICHO TURNPIKE, NEW HYDE PARK, NY 11040

Tel: 800-852-5050 • 516-328-3351 • Fax: 516-326-9125

www.tanealarm.com • E-MAIL: info@tanealarm.com